

16

NEB/J 25 R

Power supply connectors



Power supply chassis socket, angular version, with break contact, for printed circuit boards

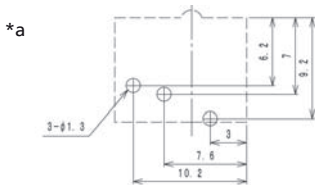
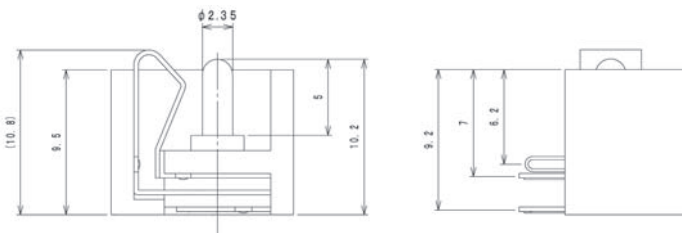
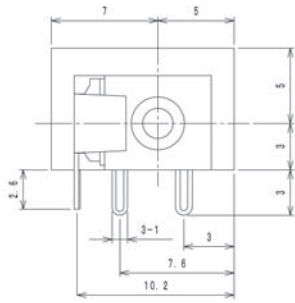

\*a printed circuit board layout, solder side view



**Environmental conditions**

Temperature range -20 °C/+70 °C

**Materials**

Insulating body PF  
Contact CuZn/CuSn, nickel-plated/silver-plated  
Housing PBT, HB according to UL94

**Mechanical data**

Diameter opening 6.0 mm  
Diameter center pin 2.35 mm  
Mating cycles  $\geq 5000$   
Insertion force 5–20 N<sup>1</sup>  
Withdrawal force 4–15 N<sup>1</sup>

<sup>1</sup> measured with a gauge plug

**Electrical data (at T<sub>amb</sub> 20 °C)**

Contact resistance  $\leq 30$  mΩ  
Rated current 1 A  
Rated voltage 12 V DC  
Rated impulse voltage 500 V/60 s  
Insulation resistance  $\geq 100$  MΩ

**Associated products**

Counterparts  
 ☞ 1633 04      ☞ 1634 02      ☞ NES/J 25  
 ☞ NES/J 250      ☞ XNES/J 250

16

NEB/J 25 R

Designation	Pole Number	PU (Pieces)	MDQ (Pieces)
NEB/J 25 R	2	250	750

**Packaging:**

in bulk, in a cardboard box or a plastic bag